

NOTES:

- DO NOT SCALE. USE FIGURED DIMENSIONS ONLY.
- THIS DRAWING IS TO BE READ IN CONJUNCTION WITH ALL OTHER RELEVANT ARCHITECTURAL AND ENGINEERING DRAWINGS.

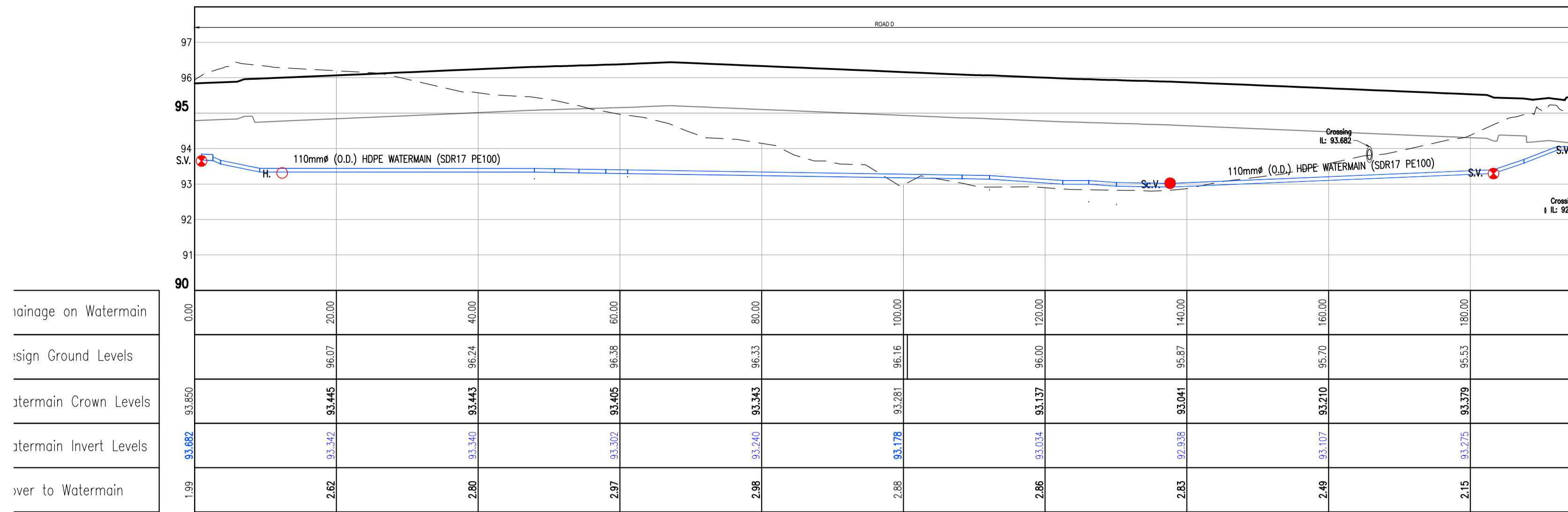

LONGSECTION 12-081A - 110MM ROAD D
H-SCALE 1:500 V-SCALE 1:100

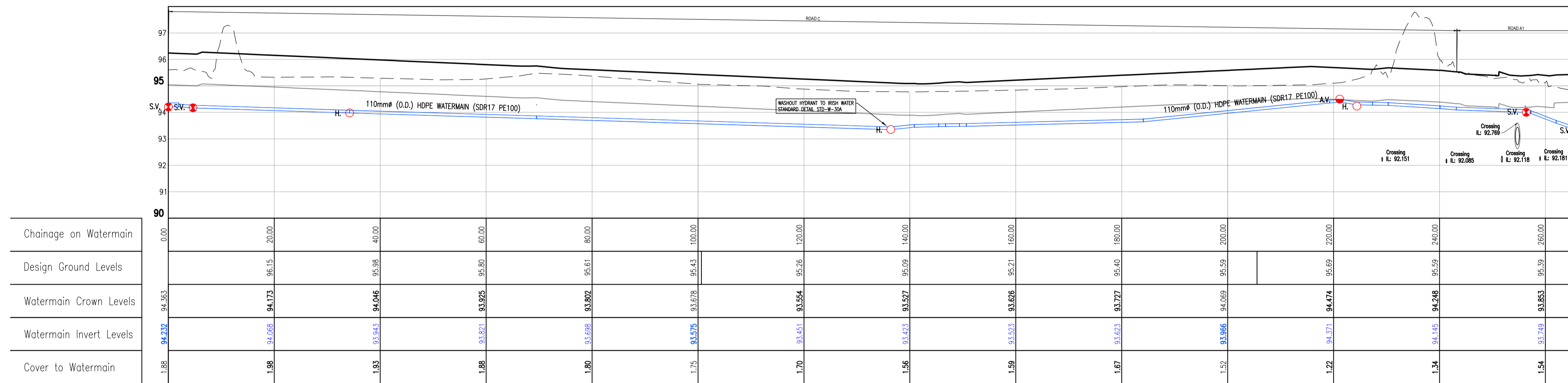

LONGSECTION 12-081A - 110MM ROAD C
H-SCALE 1:500 V-SCALE 1:100

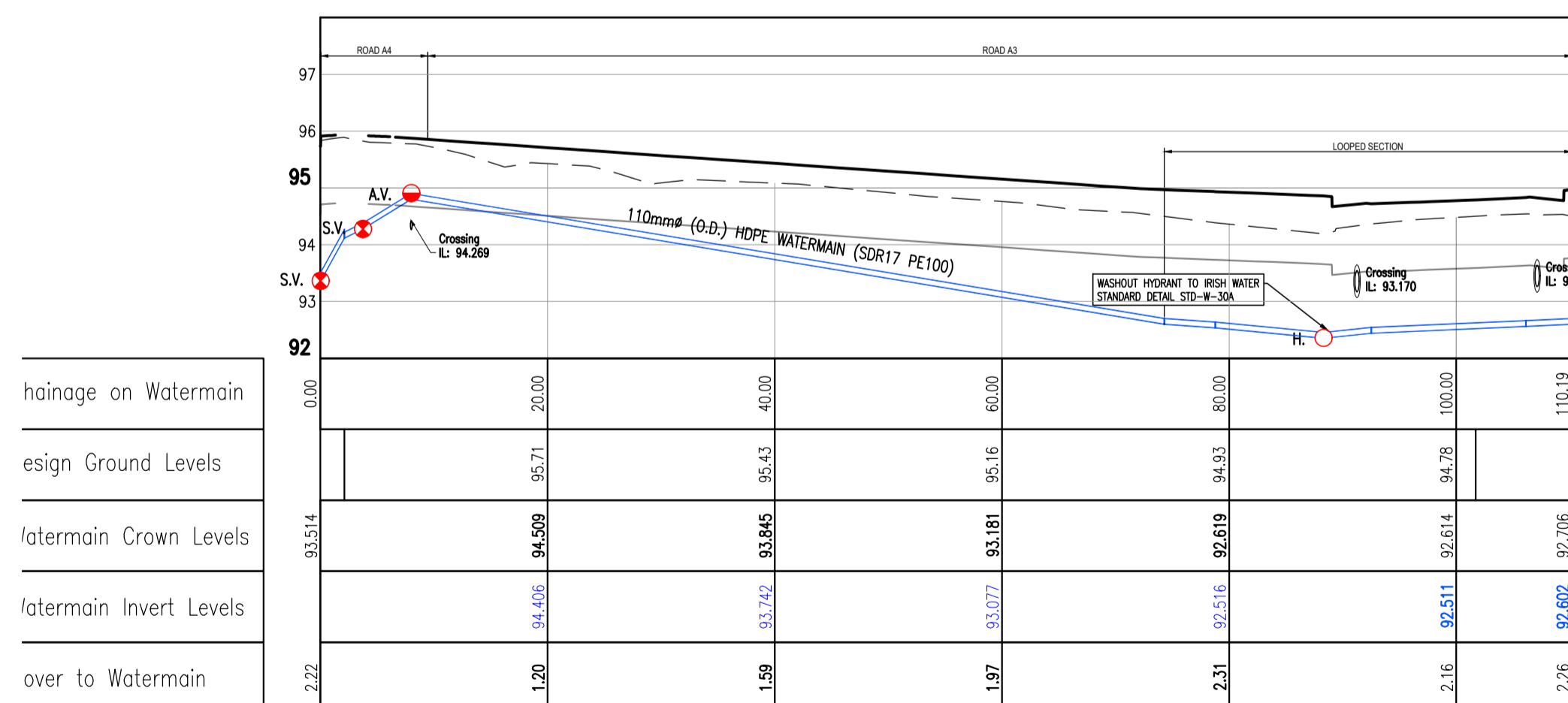

LONGSECTION 12-081A - 110MM ROAD A3 LOOP
H-SCALE 1:500 V-SCALE 1:100

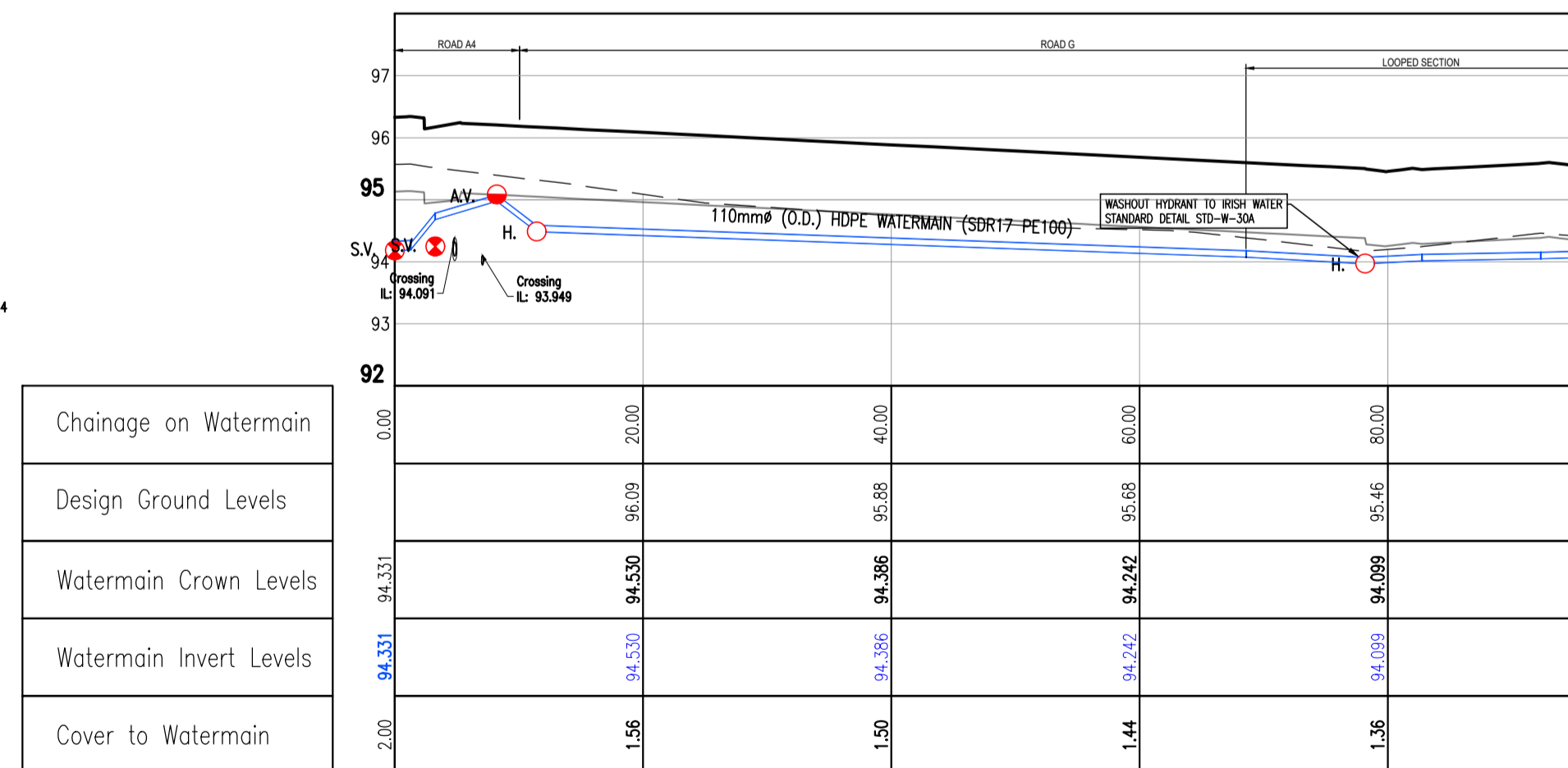

LONGSECTION 12-081A - 110MM ROAD G LOOP
H-SCALE 1:500 V-SCALE 1:100

LEGEND

- DESIGNED GROUND PROFILE
- EXISTING GROUND PROFILE
- 1200mm COVER
- Sc.V. SCOUR VALVE
- A.V. AIR VALVE
- S.V. SLUICE VALVE
- H. HYDRANT
- PROPOSED WATER PIPES
- CROSSING PIPES

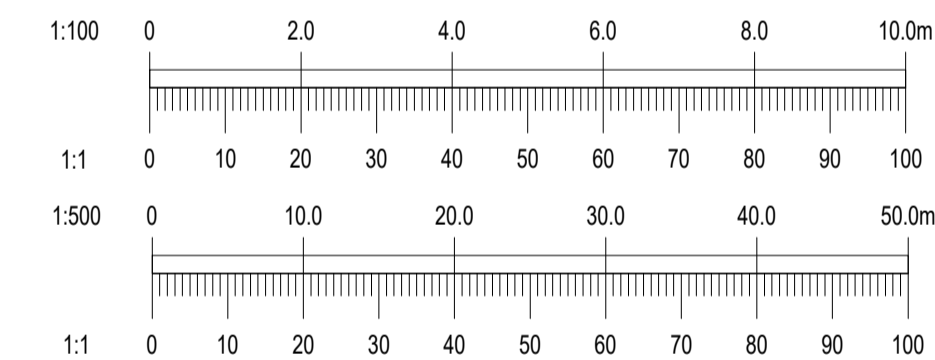

REV.	DATE	AMENDMENT	DRN	APPD
02/10/20			MK	IS

STATUS **FOR SHD APPLICATION**

Waterman Moylan
Engineering Consultants
BLOCK S, EASTPOINT BUSINESS PARK, ALFIE BYRNE ROAD,
DUBLIN D03 H3F4 IRELAND. Tel: (01) 664 8900
Email: info@waterman-moylan.ie www.waterman-moylan.ie

CLIENT	CASTELTHORN CONSTRUCTION ULC
ARCHITECT	O'MAHONY PIKE ARCHITECTS
PROJECT	PROPOSED PHASE 2 RESIDENTIAL DEVELOPMENT AT DUNSHAUGHLIN, CO. MEATH
TITLE	WATERMAIN LONG SECTIONS SHEET 5 OF 6

DRAWN MK	DESIGNED KV	APPROVED IS	DATE OCT. 2020
SCALE AS SHOWN @ A1	JOB NO. 12-081A	DRG. NO. P324	REVISION ~